

Electronic Locks

OTS 20



PRODUCT DESCRIPTION

OTS, the first batteryless electronic lock on the market. Turn your corporate office or Fitness centre into a more sustainable space.

DIMENSIONS

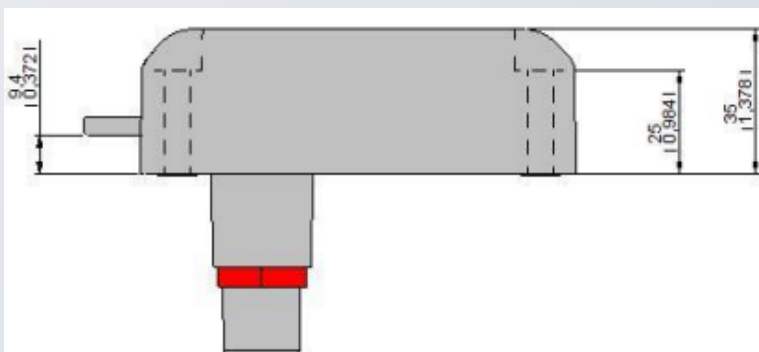
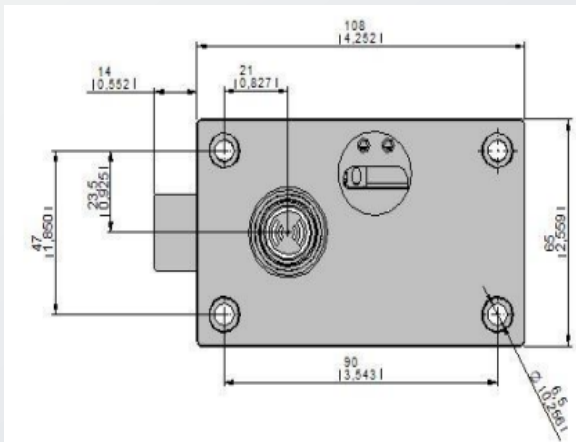

APPLICATION

- Gym
- Swimming Pools
- Office Buildings
- School

FEATURES

- Batteryless
- Fully Recyclable
- Maximum Security: Encrypted data transmission
- Maintenance-free
- Compatible with MIFARE® (DESFire EV1 / EV2, Ultralight / C, Classic 1K/4K 4B and 7B UID) | Fudan F08 1K/4K
- IK52 / IK09

TECHNICAL DATA

AUTHENTICATION MODES

Authentication mode	RFID
Supported technologies	MIFARE® (DESFire EV1 & EV2, Ultralight, Ultralight C, Classic 1K/4K 4B and 7B UID – ISO/IEC 14443), Fudan F08 1K/4K
Reading	UID / Sector / Application / File / Page
Wearables	RFID cards, wristbands, FOBs, Techno-gym key, Stickers & Transponders
Reading range	Up to 2 cm (pressing the knob)

USAGE MODES

Free mode	Control up to 3 locks with a single wearable
Dedicated mode with autocancellation	Control up to 6 locks with one wearable (only one wearable per lock)
Dedicated mode without autocancellation	Control up to 6 locks with one wearable (multiple wearables per lock).
Multifunction mode	Control up to 3 free and 3 dedicated locks with one wearable

USER INTERFACES

Lock status	Indication of locked and unlocked position
-------------	--

COMMUNICATION INTERFACES

Communication standard	NFC
Encryption mode	AES 256
Reading field range	Up to 2 cm (pressing the knob)
Number of maximum connections	1

POWER SUPPLY

No battery required	Generates its own energy when using the lock
Environment	Eco-friendly as batteries are not required

MECHANICAL CHARACTERISTICS

Dimensions	108 mm x 65 mm x 35 mm
Weight	223g
Housing	Black PANTONE 426 C
Closing resistance	DIN 4547-2 Class C
Maximum tightening torque	300 cN/m
Cycles	60.000 cycles

ENVIROMENTAL CONDITIONS

Storage temperature	-15°C to 60°C
Function temperature	0°C to 42°C (interiors)
Humidity	UNE-EN ISO 16750-4 / UNE-EN 60068-2-38, RH 96%
Protection class	IP52 according to DIN EN 60529 IK09 according to DIN EN 62262

ORDER CODES

VERSIONS

OTS

ORDER CODES

R-EA-EEL-OTS20

PRODUCT IMAGES

